

EP 7 - dynamic in-earphones

EN

Dual system with passive crossover

- ✓ InEar Headphone
- ✓ 22 ohm
- ✓ 120 dB
- ✓ 12 Hz - 22 kHz
- ✓ Transparent
- ✓ Cord length 150 cm
- ✓ 3.5 mm stereo angle phone jack
- ✓ Various silicon sleeves included
- ✓ Carrying case and bag

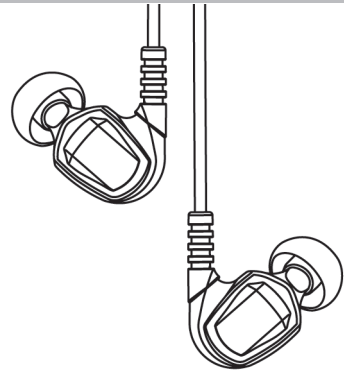

Insert the earphones into the ear canal with the cable facing up and slightly twist it backward until the sleeves feel like sealing the ear canal.

- ① Precise high frequency driver
- ② Precise low frequency driver
- ③ Internal crossover
- ④ Audio filters

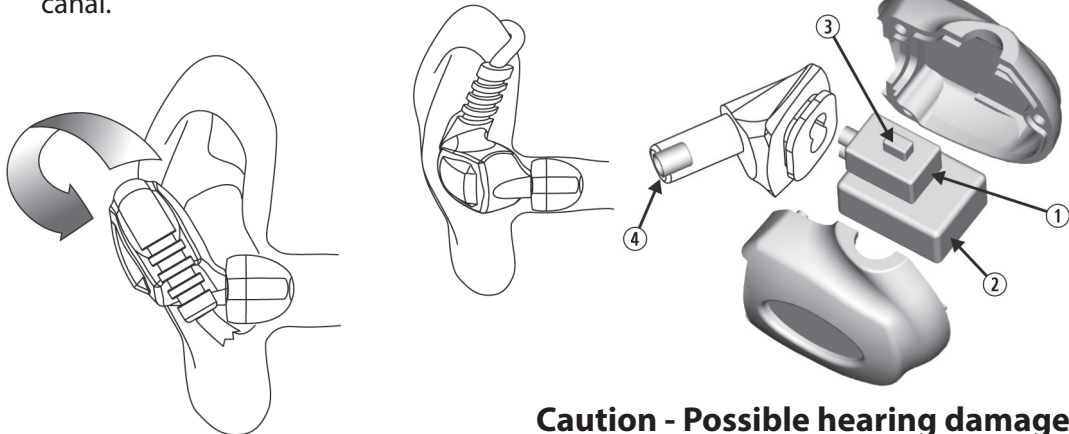

Caution - Possible hearing damage

These earphones can produce volume levels that may cause temporary or permanent hearing impairment. Do not operate the device permanently at a high volume level. Decrease the volume level immediately if you experience ringing in your ears or hearing impairment.

Frequency response	12 Hz - 22.000 Hz
Sensitivity	120 dB/mW @ 1 kHz
Impedance	22 Ω @ 1 kHz
Isolation	25 dB
Max. input power	150 mW
Distortion	< 0.3 %
Cord length	1.4 m (55")
Weight	27 g (without cable)
Audio connector	gold-plated 3.5 mm stereo phone jack

Thomann GmbH
Hans-Thomann-Str. 1 • 96138 Burgebrach
Germany • www.thomann.de

the
t.bone