

slate

MEDIA TECHNOLOGY

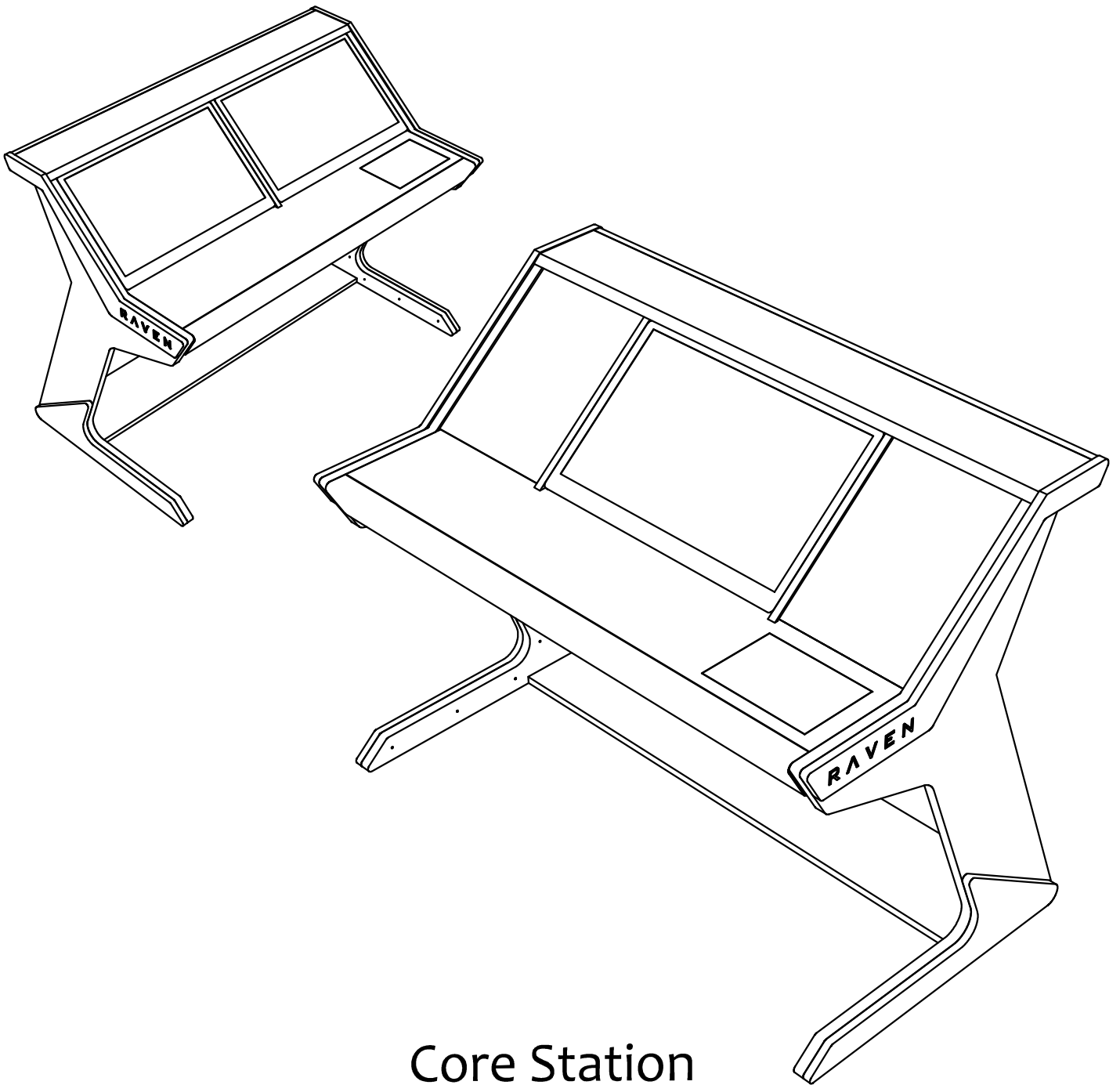

Core Station
Assembly Manual

Here is a general instruction on how to use the furniture assembly kits:

- 1) Insert and screw in the system bolt(s) into the socket(s) already present on the part(s) making sure the hole is at 90° from the edge
- 2) Assemble the connecting parts, inserting the bolts into the smaller holes in the connecting part, the bolt tip fitting into the side hole of the excenter until the hole in the bolt and the center hole of the excenter align
- 3) insert the locking screw into the excenter, and tighten with a cross screw driver all the way without using force!



System bolt with hole



Excenter whit 2 holes



Locking screws

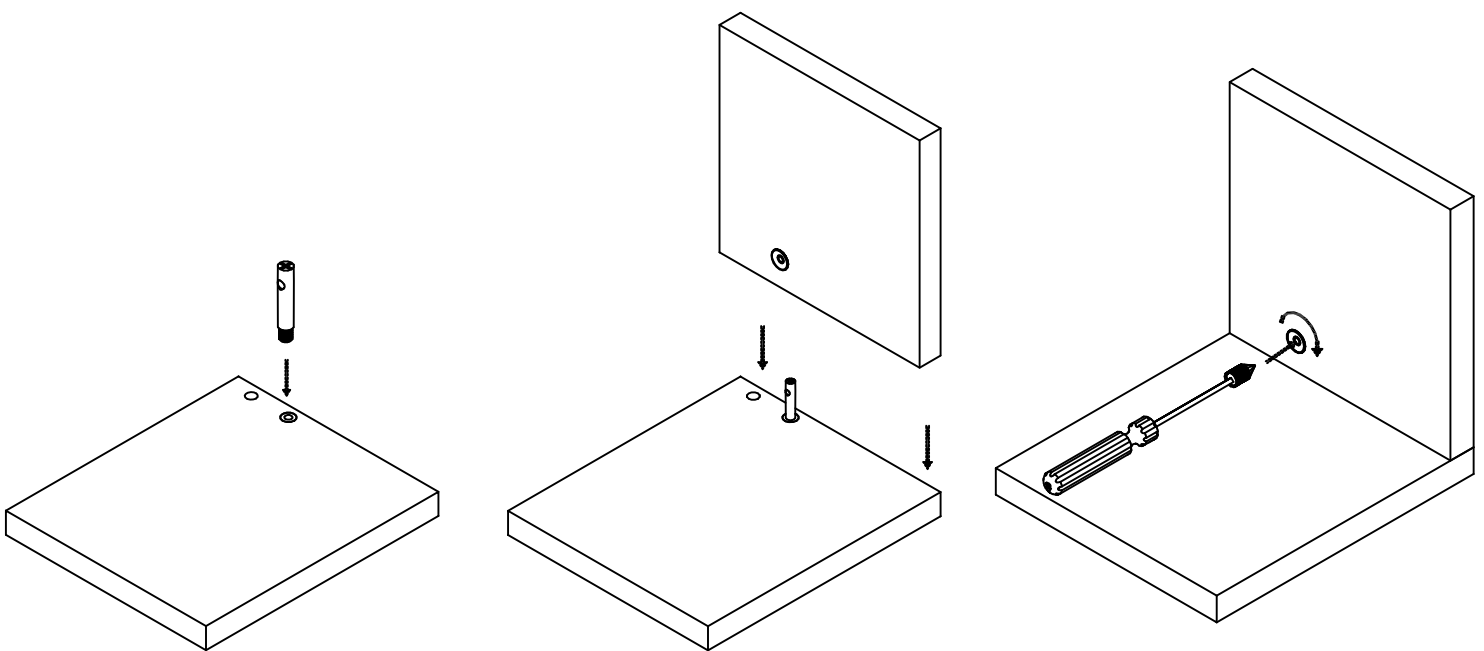

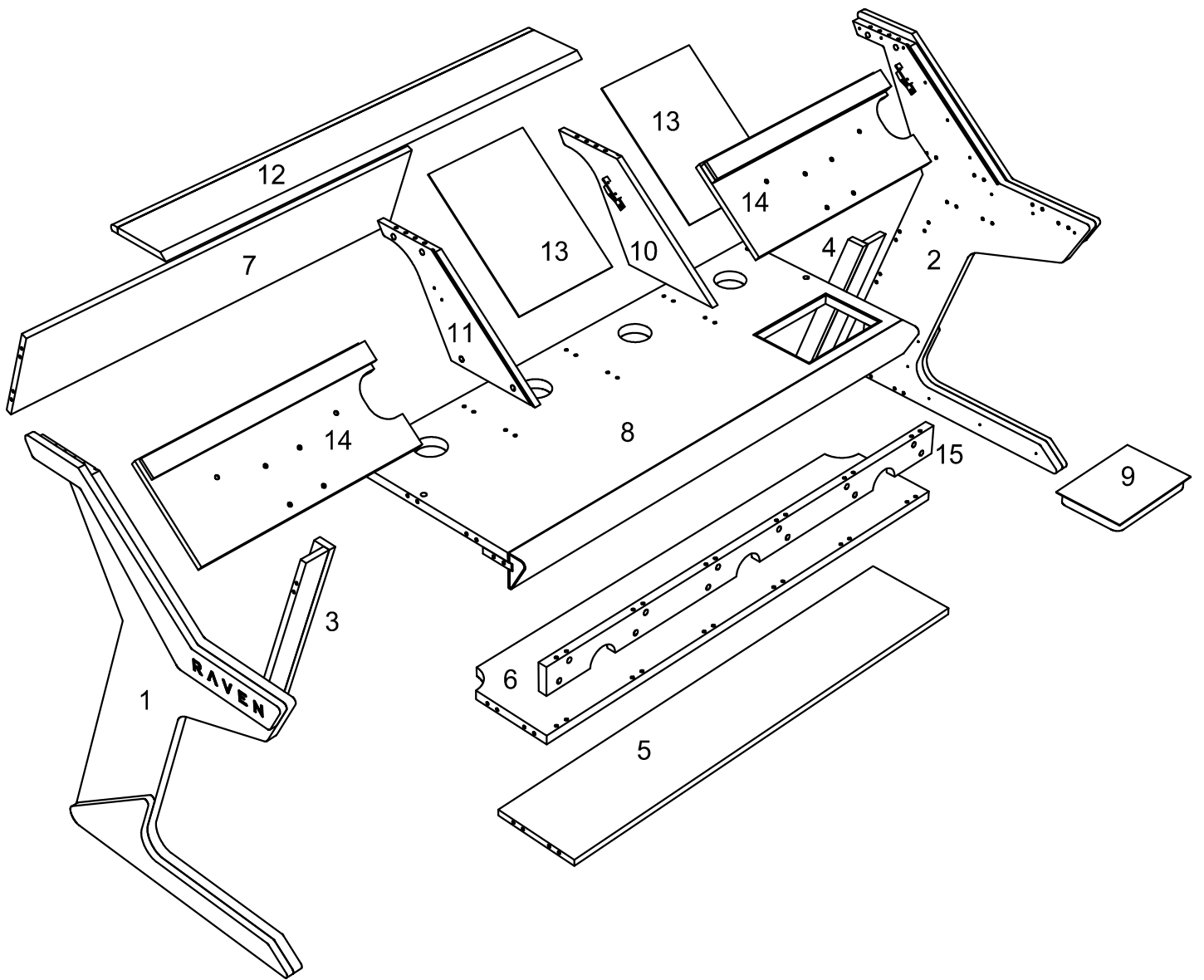

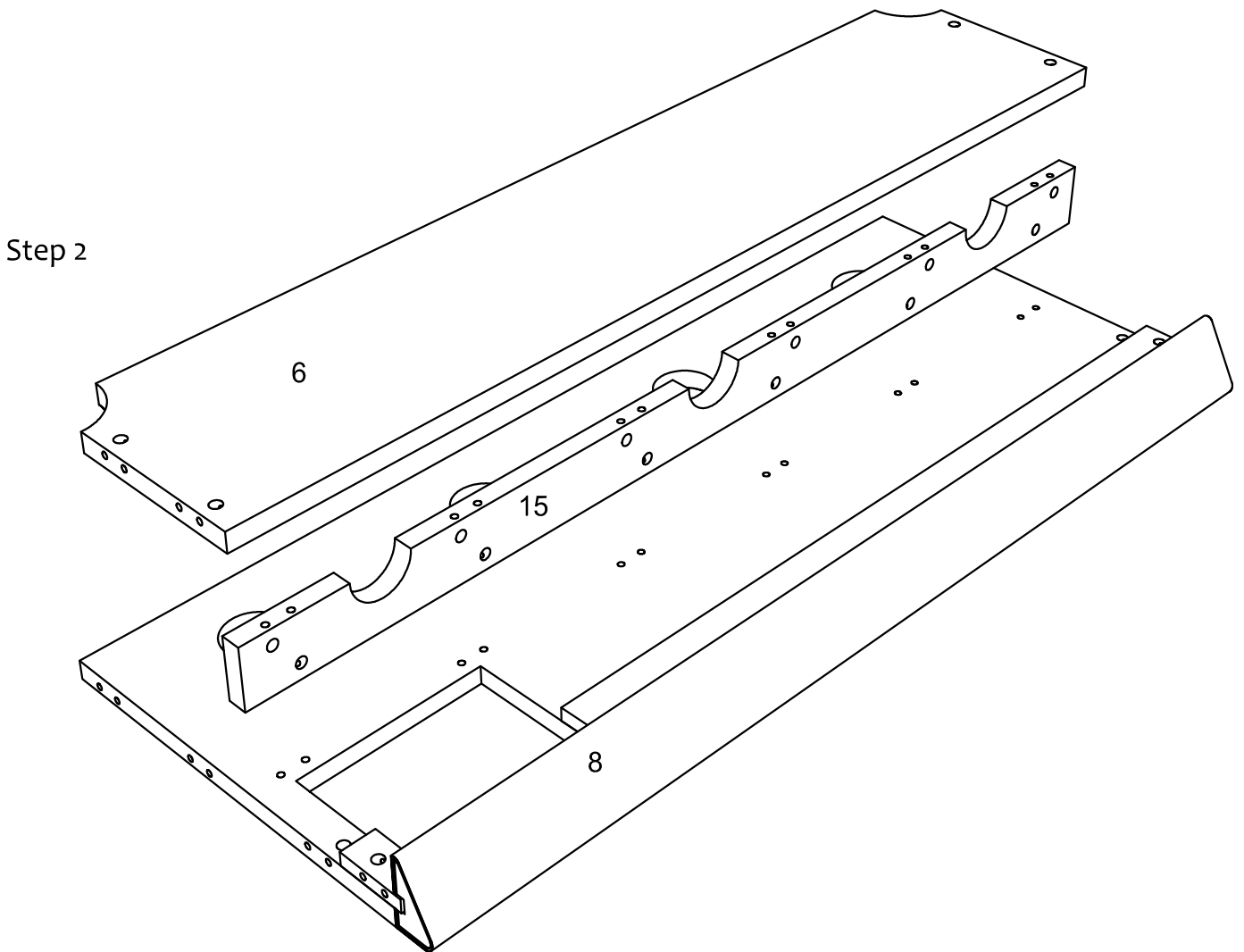
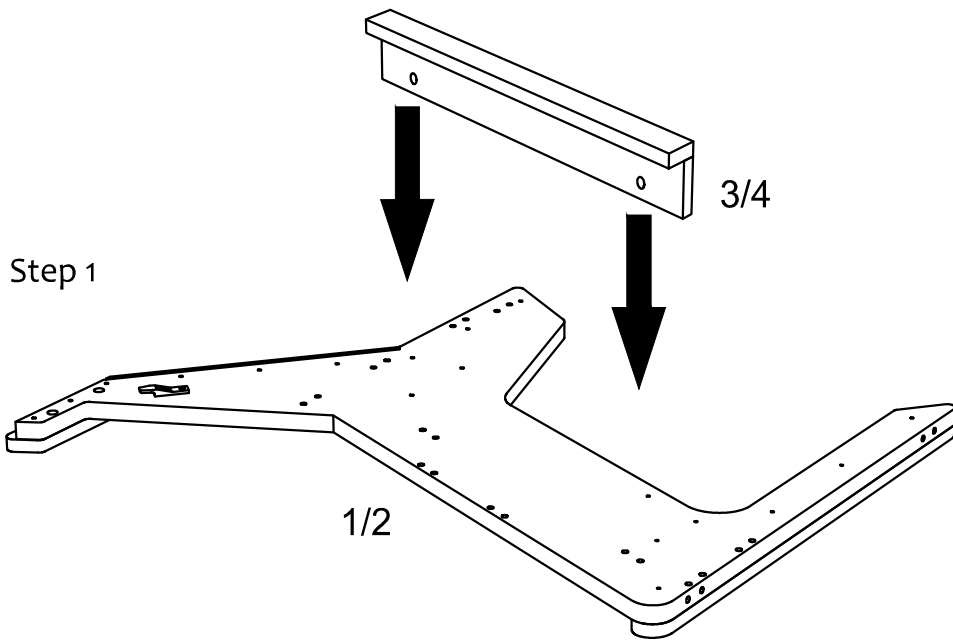

Step 3

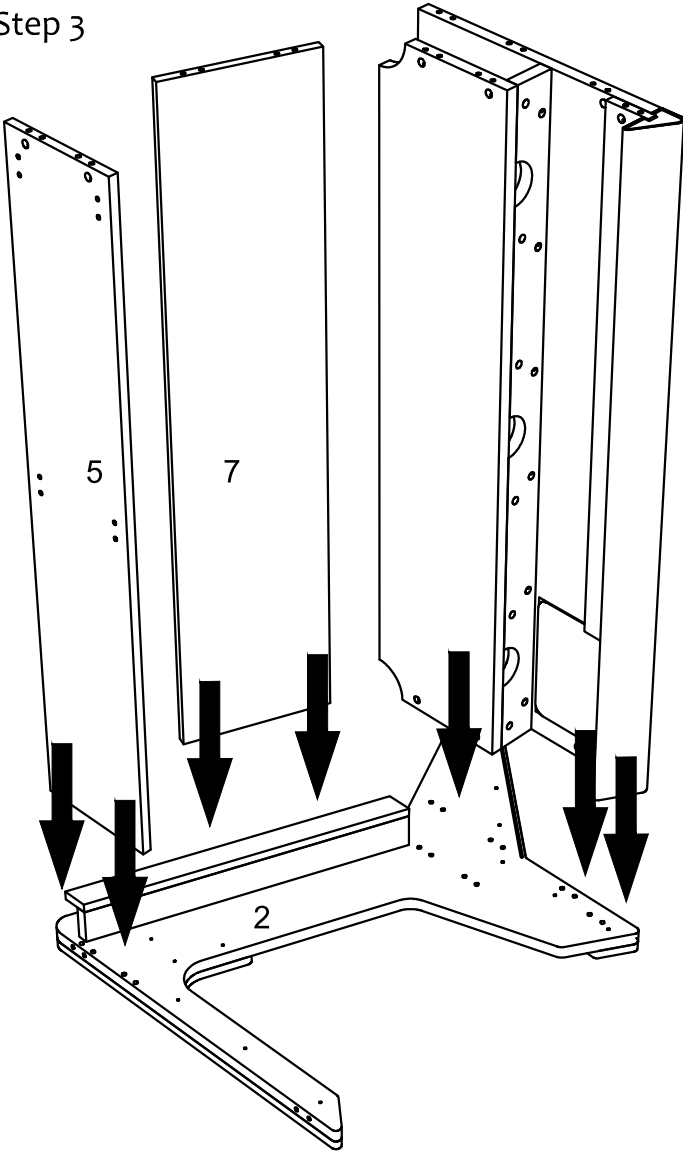

Step 4

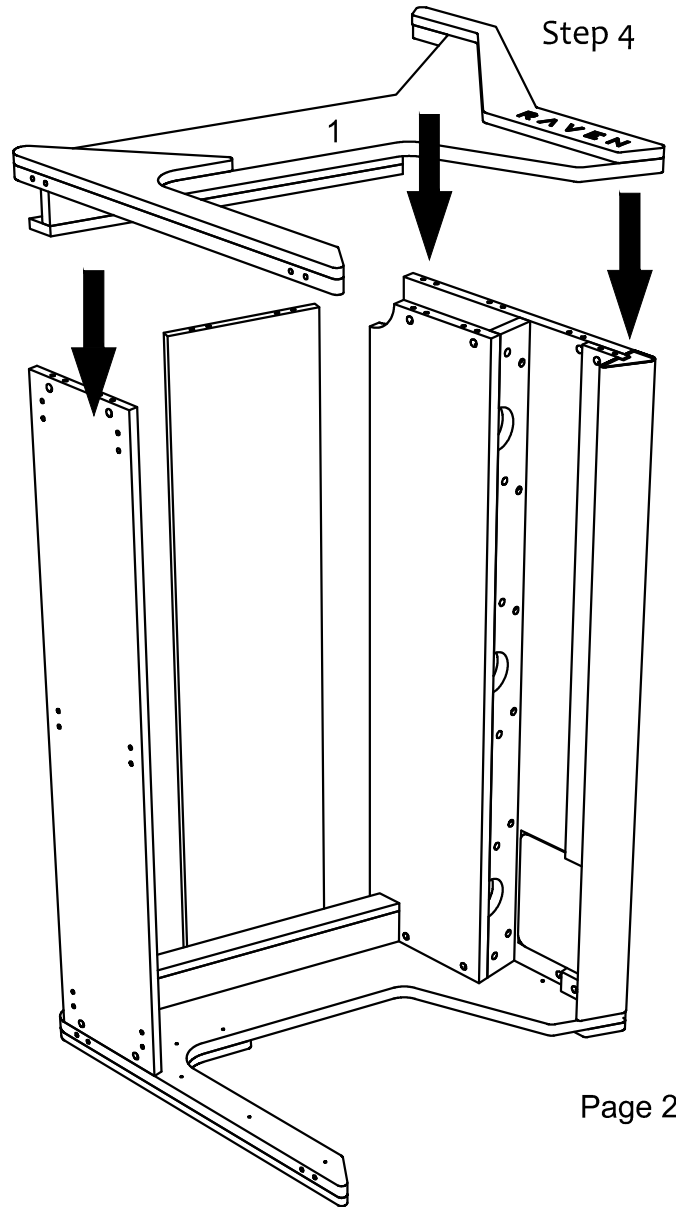

Step 5

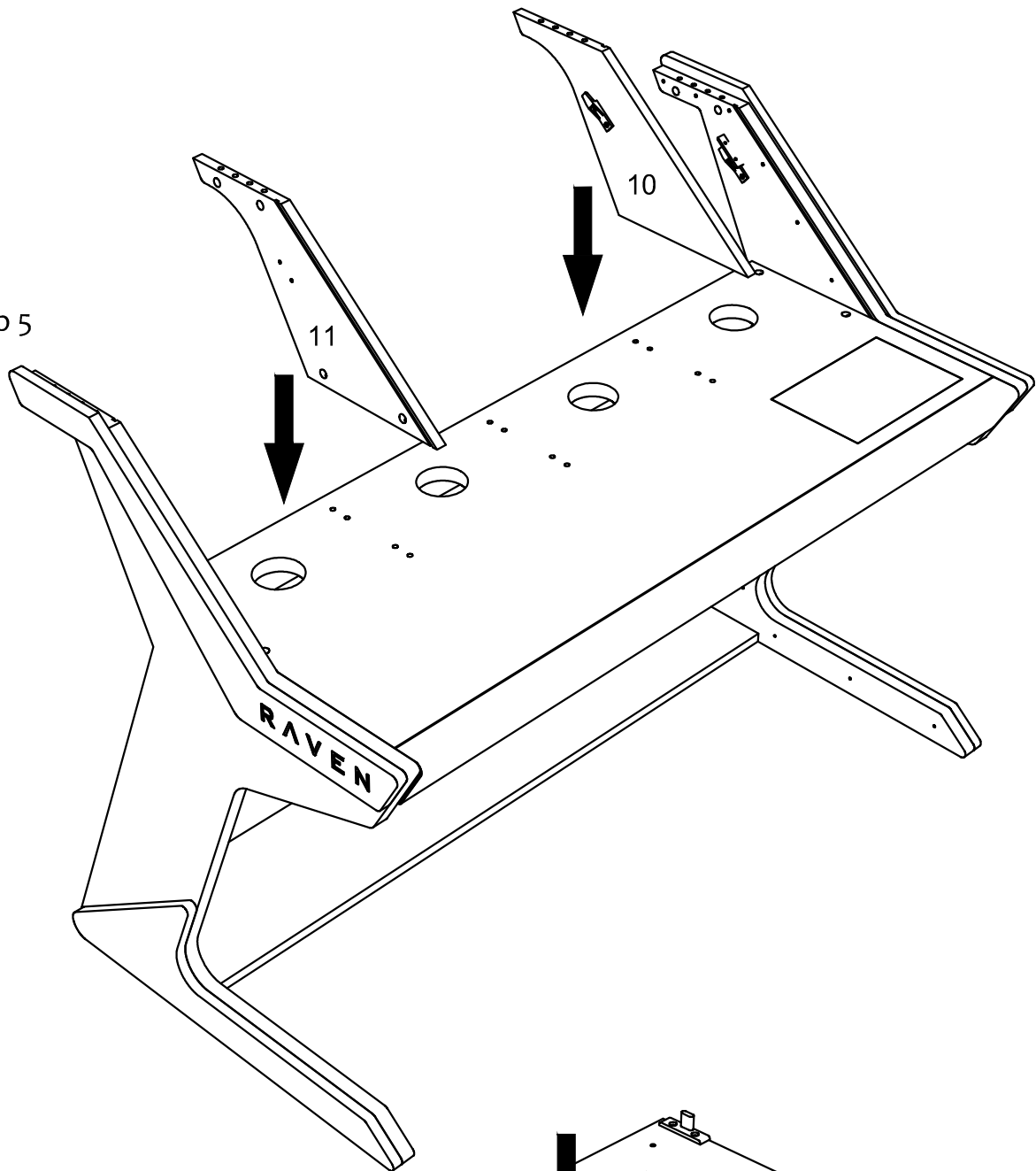

Step 6

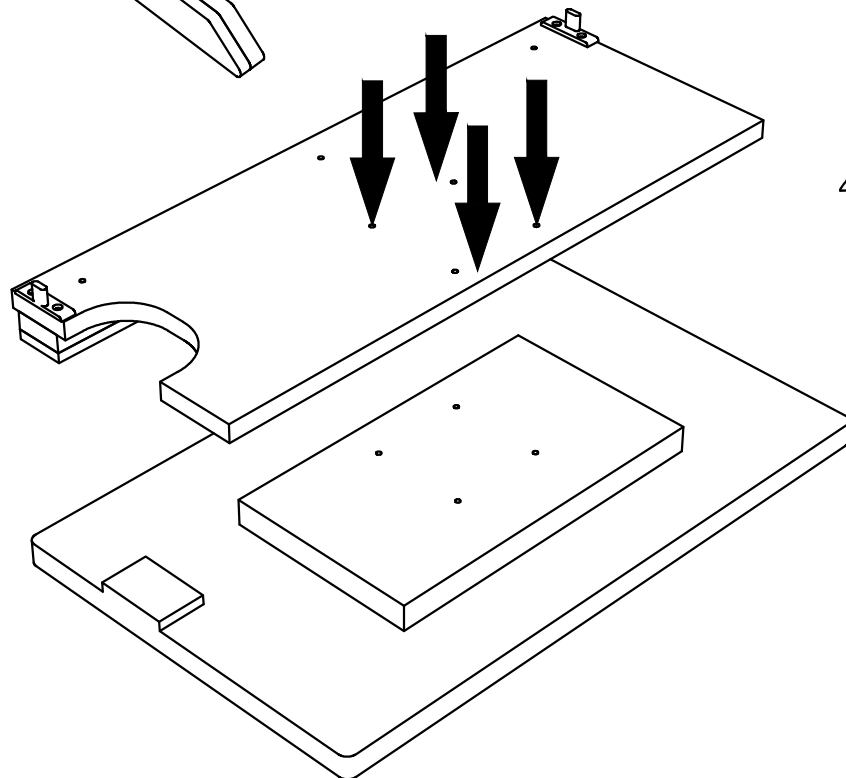

4x m4x25 mm

Step 7

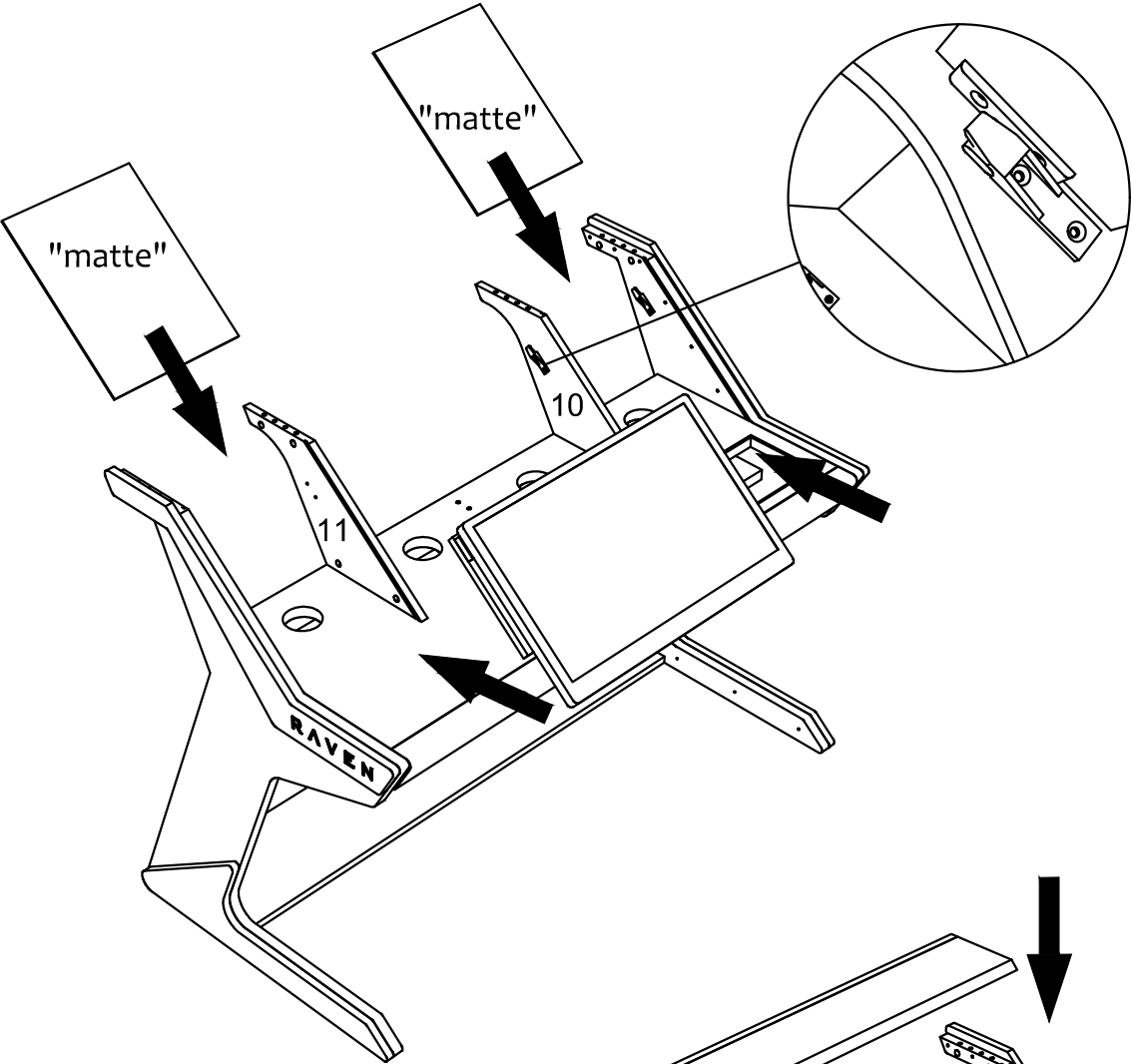

Step 8

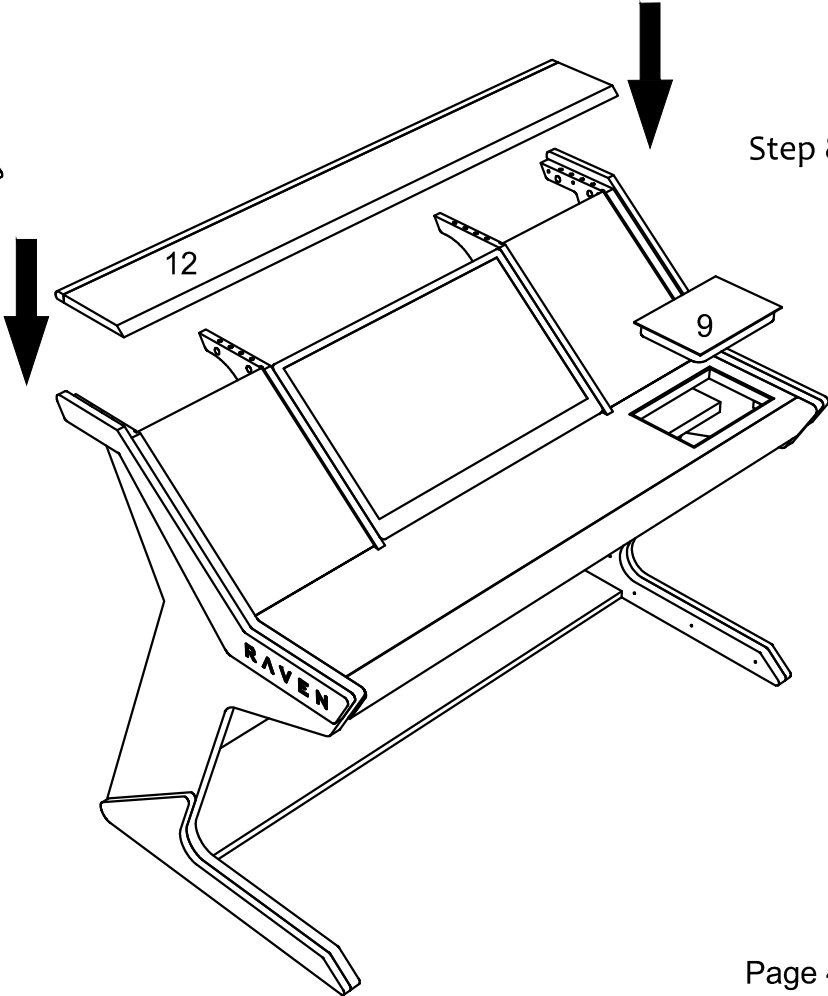

For 2 MTis: Step 1...4;

Unmount the support from piece #11 and mount it on piece #10.
Use Pozidriv #2 screwdriver.

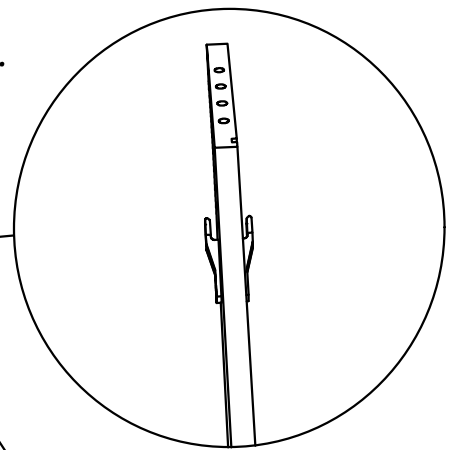

Step 5

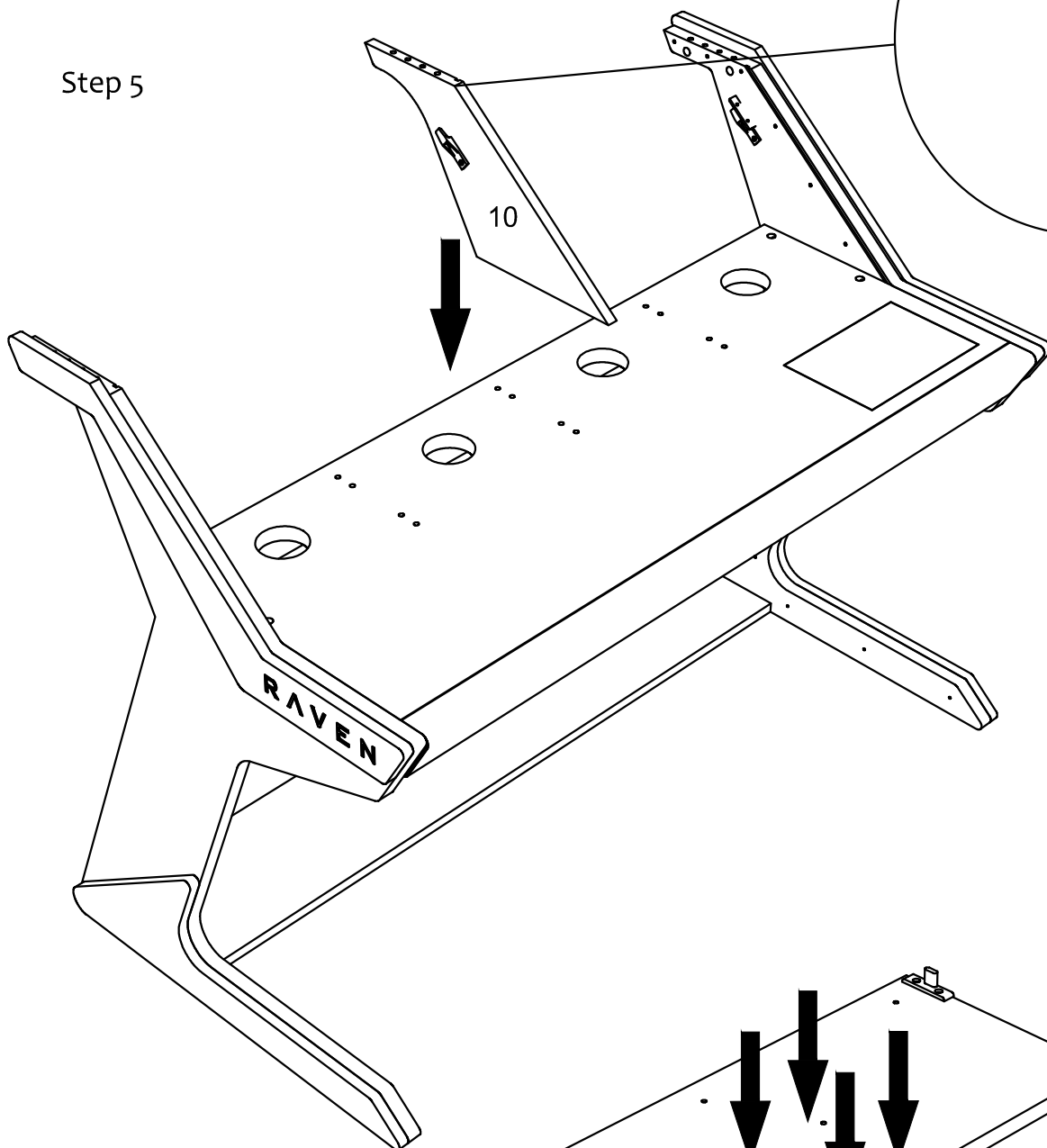

Step 6

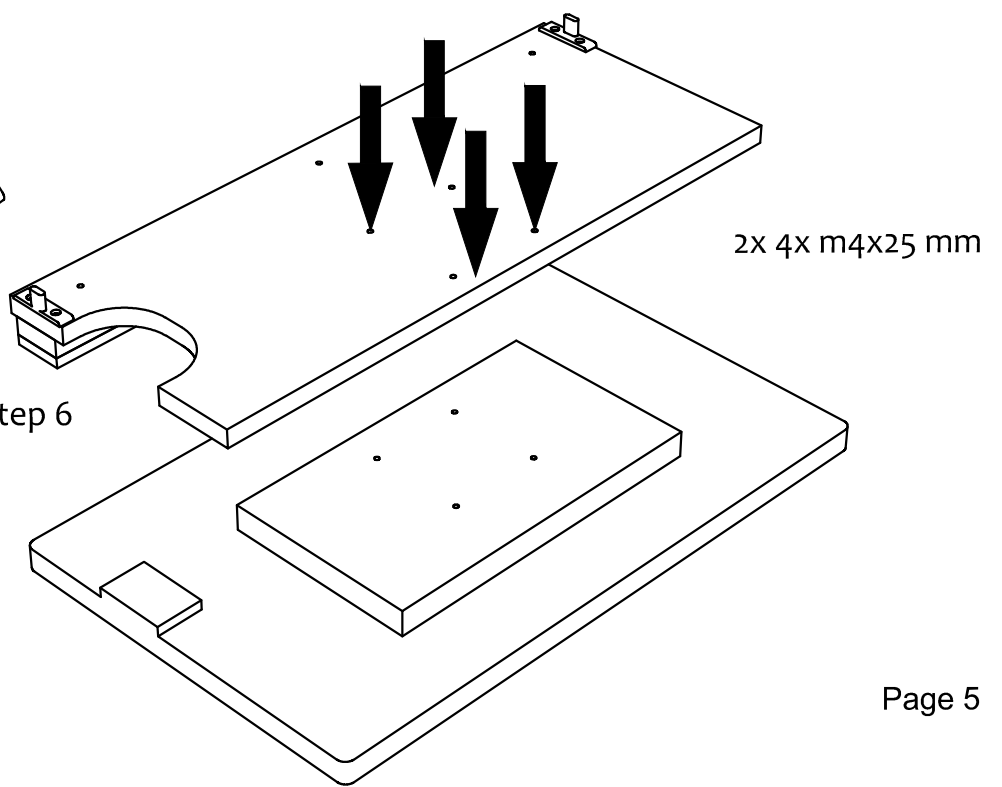

For 2 MTis:
Step 7

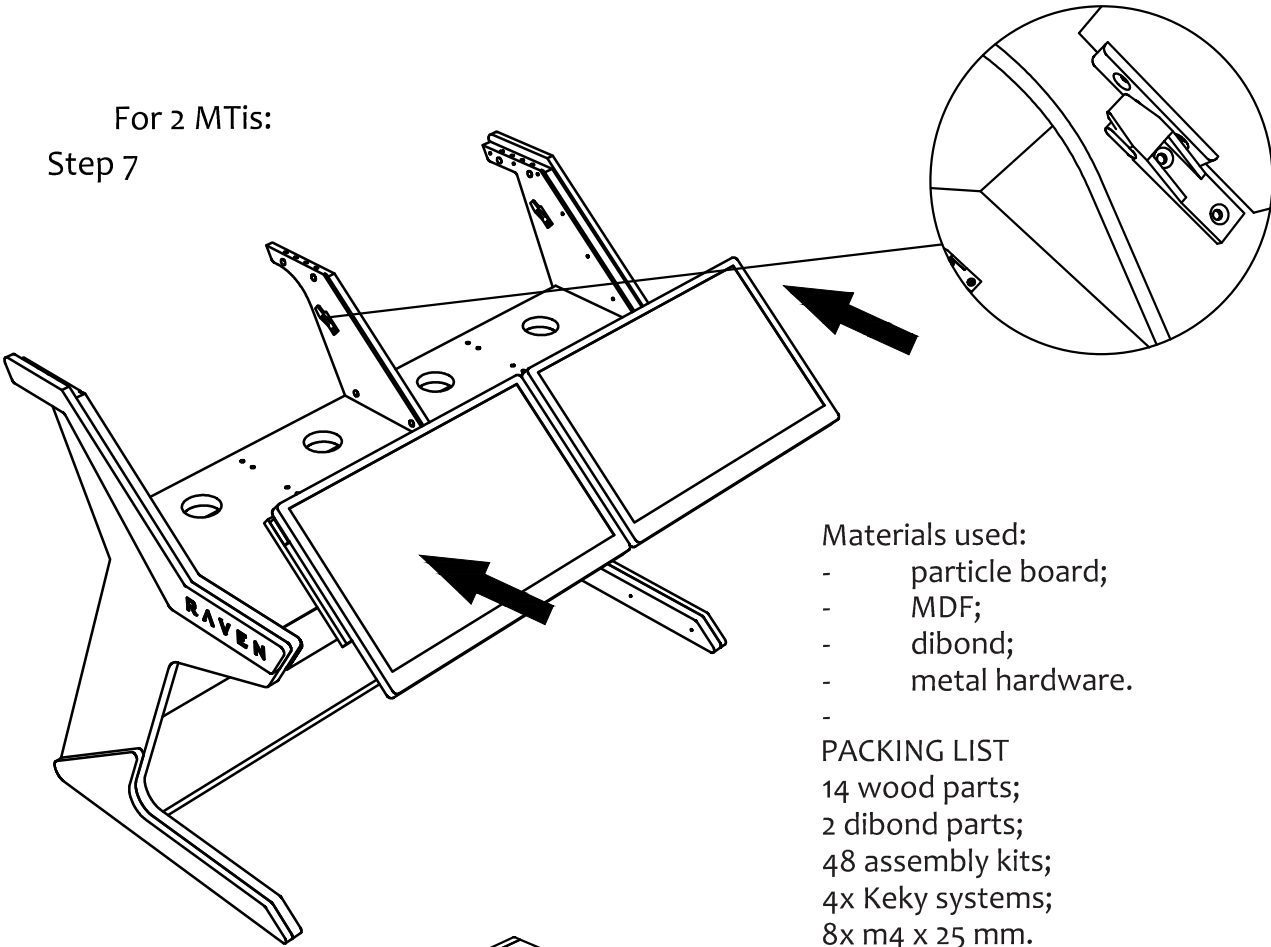

Materials used:
- particle board;
- MDF;
- dibond;
- metal hardware.

PACKING LIST
14 wood parts;
2 dibond parts;
48 assembly kits;
4x Kkey systems;
8x m4 x 25 mm.

Instructions for use and cleaning
- clean with a soft cloth, slightly humid
or specific products for wood or lacquer;
- avoid the use of abrasive cleaners!
For assembly we recommend being at
least two people.

Step 8

