



Bluetooth Receiver

Quick Start Guide

This quick start guide contains important information on the safe operation of the product. Read and follow the safety advice and instructions given. Retain the manual for future reference. If you pass the product on to others please include this manual.

Safety instructions

Intended use

This device is used for wireless transmission of digital audio signals via Bluetooth and their conversion to analogue signals for further processing. Any other use or use under other operating conditions is considered to be improper and may result in personal injury or property damage. No liability will be assumed for damages resulting from improper use.

Danger for children



Ensure that plastic bags, packaging, etc. are disposed of properly and are not within reach of babies and young children. Choking hazard! Ensure that children do not detach any small parts from the product. They could swallow the pieces and choke!

Incorrect handling of lithium batteries can result in injury

- In the event of a short circuit, overheating or mechanical damage, lithium batteries can cause severe injuries.
- Store lithium batteries in a cool, dry place, away from heat sources, ideally in the original packaging.

- Lithium batteries are hermetically sealed. Never attempt to open a lithium battery.
- Only use powder extinguishers or other suitable extinguishing agents to extinguish a burning device containing lithium batteries.

Where to use the product

- Never use the product
- in conditions of extreme temperature or humidity
- in extremely dusty or dirty areas
- at locations where the unit can become wet

Electromagnetic compatibility with other electrical equipment

Using the device near radios or TV sets may cause interference. In this case, increase the distance between both devices.

General handling

- To prevent damage, never use force when handling the product.
- Never immerse the product in water. Just wipe it with a clean dry cloth. Do not use liquid cleaners such as benzene, thinners or flammable cleaning agents.

Features

- Bluetooth transmission system
- XLR output
- Built-in rechargeable battery
- Includes Micro USB charging cable

Operating elements

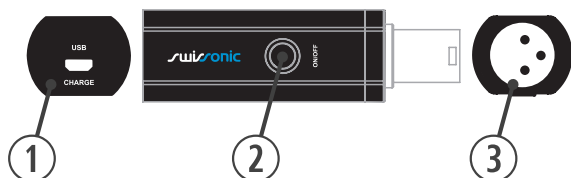

- ① Micro USB charging port
- ② On / off switch
- ③ XLR output, unbalanced

Using the product

1. Press the on / off switch (②) to turn on the unit.
2. If the LED flashes red, the built-in battery must be charged. To do this, connect the device's micro USB charging port (①) to a USB power source using the supplied charging cable. When the charging process is complete, the LED lights green. Then disconnect the device from the USB power source.
3. When the LED is flashing green and red, the device is ready to connect to a Bluetooth enabled device, such as smart phone, tablet or the like. Then establish the connection.
4. When connected, the LED is green.
5. Use a suitable cable to connect the XLR output (③) to the input of the device that you want to use to process the line level signals.
6. Start the media playback on the audio source.
7. To switch off the device, press the on / off switch (②).

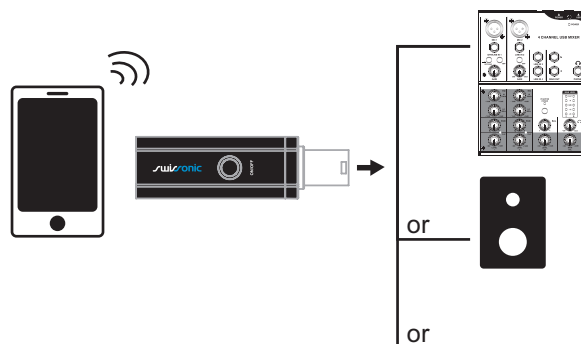

Technical specifications

Bluetooth version	V 4.0
Power supply	Rechargeable lithium polymer battery, 3.7 V 300 mAh
Standby current	< 0.5 mA
Transmission range	10 m
Sensitivity	-80 dBm $\pm 0.1\%$ BER
Signal-to-noise ratio	≥ 75 dB
Distortion	$\leq 0.1\%$
Dimensions (W x H x D)	125 mm x 32 mm x 28 mm
Weight	approx. 100 g



For the transport and protective packaging, environmentally friendly materials have been chosen that can be supplied to normal recycling. Ensure that plastic bags, packaging, etc. are properly disposed of. Do not just dispose of these materials with your normal household waste, but make sure that they are collected for recycling. Please follow the notes and markings on the packaging.



Remove replaceable lithium batteries from the device before disposal. Protect used lithium batteries from short circuits, for example by covering the poles with adhesive tape. Permanently installed lithium batteries must be disposed of together with the device. Please inquire about a suitable acceptance point.



This product is subject to the European Waste Electrical and Electronic Equipment Directive (WEEE) in its currently valid version. Do not dispose of your old device with your normal household waste. Dispose of this product through an approved waste disposal firm or through your local waste facility. Comply with the rules and regulations that apply in your country. If in doubt, consult your local waste disposal facility.